

KLARUS®



Mi7 Ti

Mini-Might Illumination AA Flashlight

Features

- CREE XP-L HI V3 LED, up to 50,000 hours life
- Maximum output 700 Lumens, Maximum runtime 67 hours
- Small and lightweight for everyday carry (40g without battery)
- TC4 Titanium alloy body- permanent colour, corrosion & scratch resistant finish
- Battery Capacity Indication displays remaining power for easy monitoring
- One Touch Access to Moon-light and High output levels
- Unique high efficiency circuit with broad voltage range to accommodate both AA (Primary/Rechargeable) and Li-ion 14500 batteries
- Constant Current Control with no PWM flash; suitable for photography illumination
- Over-Discharge Protection automatically lowers output levels to protect rechargeable batteries
- Lock-Out mode specially designed to prevent accidental activation of the flashlight
- Reverse Polarity Protection for ease of use
- Exclusive Stainless Steel switch; Elegant, Ergonomic, Easy to use
- AR (Anti-Reflective) coated Mineral Lens hardened for scratch resistance
- IPX-8 water protection (2 meters submersible rating)

Specifications

- CREE XP-L HI V3 LED; 50,000 hours life
- Voltage Range: 1.0V – 4.2V
- Battery: AA x 1; Li-ion 14500 x 1
- Reflector: Orange Peel
- Switch: Side Switch
- Material: Titanium alloy
- Weight: 40g (1.41oz) (without battery)
- Protection: IPX-8 rating (up to 2 meters submersible)

• 3 output levels, 2 strobe patterns

Specification	Mode	High	Low	Moonlight	Strobe	SOS
ANSI lumens (LM) 14500		700	90	5	700	90
Runtime(h) 14500		53min	3h	67h	1h	11h
ANSI lumens (LM) AA		330	90	5	300	90
Runtime(h) AA		55min	1h	40h	1h	5h
Peak beam intensity(cd)		3025				
Max beam distance(m)		110				
Impact resistance(m)		1				
Waterproof		IPX8(under water 2m)				

- Lens: Hardened Mineral Glass; AR coated; Scratch resistant
- Accessories: O-ring x1, AA Battery x1, Keyring x1, Clip x1 Lanyard x1

Operation

Side Switch:

One Touch Access:

- From "off" mode, long press to enter Moon-light output level, quick click to turn off flashlight
- From "off" mode, quick click to enter High output level, click again to enter Low level, click again to turn off flashlight
- Lock-out:**
- Hold the switch for more than 5 seconds to engage Lock-out mode, indicated by 2 flashes
- In Lock-out mode, click the switch 3 times. The Lock-out mode is disengaged after 1-3 flashes, depending on the capacity remaining. (Over 70% capacity remaining, 3 flashes; Between 30% - 70% capacity remaining, 2 flashes; Less than 30% capacity remaining, 1 flash)

Strobe/SOS:

- Double click the switch to enter Strobe mode; Double click again to enter SOS mode
- Single click to return to flashlight operation prior to Strobe mode

Battery Capacity Indicator

- The remaining capacity of the installed battery will be displayed after 3 clicks of the switch when the light is in "off" mode
- 3 Flashes - Over 70% capacity remaining
- 2 Flashes - Between 30% - 70% capacity remaining
- 1 Flash - Less than 30% capacity remaining

Over-Discharge Protection

- With regular or rechargeable AA batteries, the output level will automatically drop to a lower level when the battery drops below 0.8V until the battery is completely drained.
- With rechargeable Li-ion 14500 batteries, the output level will automatically drop to a lower level when the battery drops below 3.0V to prevent over-discharge of the battery
- With rechargeable Li-ion 14500 batteries and the output level set at maximum, the output will be lowered automatically after 3 minutes to prevent overheating and damaging the electrical circuits and LED

Usage and Maintenance

- The flashlight's surface will increase in temperature during use, especially during periods of higher lumen output. The maximum safe operating surface temperature of the flashlight is 60°C /140 F
- Please fully charge battery before initial use. Included battery is charged to less than 50% as a safety measure and will not power the flashlight at full specification without charging

- Do not shine light directly into eyes
- Remove battery when stored for extended periods
- Please unscrew the light's body to avoid accidentally switching the light ON when not wanted during an emergency situation
- Replace and lubricate O-Rings as needed to maintain IPX-8 rating

Battery Replacement

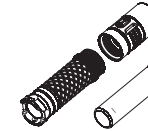

Usage and Maintenance

- The flashlight's surface will increase in temperature during use, especially during periods of higher lumen output. The maximum safe operating surface temperature of the flashlight is 60°C /140 F
- Please fully charge battery before initial use. Included battery is charged to less than 50% as a safety measure and will not power the flashlight at full specification without charging
- Do not shine light directly into eyes
- Remove battery when stored for extended periods
- Please unscrew the light's body to avoid accidentally switching the light ON when not wanted during an emergency situation
- Replace and lubricate O-Rings as needed to maintain IPX-8 rating

Warranty

- KLARUS guarantees the flashlight against defects in material and workmanship. Flashlight products that are found to be defective under normal use within 5 years of the proof of purchase date will be repaired or replaced without charge
- This warranty does not cover damage caused by accident, unreasonable use or product alteration. Failure to follow the general maintenance directions could result in damage to your flashlight that may not be covered by the KLARUS warranty

Limited lifetime warranty

If problems develop after 5 years from the date of purchase, KLARUS will charge for parts. The total repair fee will be assessed according to the cost of the replacement materials. If damage to the light is substantial, KLARUS will contact the customer via the distributor with a quote. The customer can then decide whether to proceed with the repairs or not. Freight will be paid by distributor or customer.

Warranty Procedure

- If this flashlight does not perform to the specification, the product will be repaired or replaced as described above.
- Please contact your original KLARUS dealer for replacement and repairs
- If the warranty issue cannot be resolved by the dealer, please contact KLARUS at info@klaruslight.com for assistance. Please provide the following information to expedite the process:
 - 1) List the series number on the light,
 - 2) Include a detailed description identifying the issue, accompanied by pictures or a short video demonstration if necessary
 - 3) Provide the name and store of the dealer you made the purchase from; and a copy of the proof of purchase



Website



Facebook

KLARUS LIGHTING TECHNOLOGY CO., LIMITED

Office Address: Room 521-525, Zhihuigu Innovation Park, 1010 Bulong Road, Longhua District, Shenzhen City, 518131, China
Factory Address: 5/F, No.26 Building, Niulanqian Industrial Park, Longhua District, Shenzhen City, 518131, China
Email: info@klaruslight.com Phone: +86-755-27700110
Website: www.klaruslight.com



KLARUS®



Mi7 Ti

小巧高亮AA手电

特点

- 搭载美国最新CREE XP-L HI V3 LED, 寿命长达50000小时
- 最高亮达700流明, 最长续航达67小时
- 体积小, 轻便, 方便日常携带使用(头部直径19mm, 筒身直径17.6mm, 长度87.2mm), 重量(40g, 不含电池)
- 采用TC4钛合金制造, 精致美观, 色泽恒久, 耐腐蚀, 耐刮擦
- 智能电量指示功能, 随时查看剩余电量, 使用时间自由掌控
- 一键直达月光模式和最高亮
- 特别设计的高效宽电压电路, 电池兼容性更高, AA电池(碱性电池, 镍氢电池)或者14500锂离子电池均能使用
- 恒流电路, 无频闪, 非PWM调光, 可用于照相补光
- 电池低电压保护功能, 当电池电量不足时会自动降档, 防止电池过放
- 特别为侧按开关手电设计的锁定功能, 锁定后避免在旅行包内误点亮消耗电量, 也可避免小孩把玩, 高亮伤害眼睛;
- 防反接设计, 防止电池装反对电路造成危害
- 特制的不锈钢开按钮, 经久耐用, 操作方便, 美观大方
- 镜片采用钢化玻璃, 镀AR膜, 防刮耐磨
- 防水等级IPX-8级(水下2米), 可在暴雨中正常使用

规格

- 采用CREE XP-L HI V3 LED, 寿命长达 50000小时
- 工作电压 1V-4.2V
- 可兼容电池: AA电池 x1, 14500电池 x1
- 反光杯: 桶面光杯
- 开关类型: 筒头侧按
- 材质: TC4钛合金
- 尺寸: 头直径19mm x 筒身直径17.6mm x 总长87.2mm
- 重量: 40g(不含电池)
- 防水: IPX-8级防水设计
- 镜片: 钢化玻璃, 镀AR膜, 防刮耐磨

• 3种亮度模式, 2种闪烁模式

ANSI/NEMA F11	高亮	低亮	月光	爆闪	SOS
亮度(LM) 14500电池	700	90	5	700	90
续航时间(h) 14500电池	53min	3h	67h	1h	11h
亮度(LM) AA电池	330	90	5	300	90
续航时间(h) AA电池	55min	1h	40h	1h	5h
最高光强度(cd)	3025				
高亮档射程(m)	110				
防跌落(m)	1				
防水级别	IPX8级防水(水下2m)				

- 配件: O型圈*1, 电池*1, 挂扣*1, 抱夹*1, 手绳*1
- 备注: 以上参数是按照国际手电筒测量标准ANSI/NEMA F11所述之方法测量所得, 所使用电池为1节KLARUS 800mAh 14500电池, 实际数据可能会随着不同电池或使用环境而产生影响. KLARUS是美国手电行业协会(PLATO)的成员, 参与制定和优化ANSI/NEMA F11手电标准, 产品测试数据标准科学
- 为了提升手电使用效率, 建议使用KLARUS凯瑞兹高可靠、高性能的800mAh 14500电池和充电器

操作说明

侧按开关

一键开关换挡: 关机状态下长按进入月光模式, 再单击关机
关机状态下单击进入高亮状态, 再单击进入低亮, 再单击进入关机状态

锁定功能: 关机或常亮档长按5S, 灯光闪烁2下后进入锁定状态; 锁定状态下, 三击, 闪烁1-3下提示解锁(闪烁次数取决于剩余电量, 剩余70%以上电量, 闪烁3下; 剩余30%-70%电量, 闪烁2下; 剩余30%以下电量, 闪烁1下)

爆闪/SOS: 任何状态下双击进入爆闪, 在爆闪模式下快速双击进入SOS, 单击退回进入闪烁前状态

电量指示

- 关机状态下三击侧按开关显示电量
- 指示灯闪烁3下, 表示剩余70%以上电量
- 指示灯闪烁2下, 表示剩余30%-70%电量
- 指示灯闪烁1下, 表示剩余30%以下电量

电池低电压保护功能

放入AA电池, 电压低于0.8V时, 会自动依次降档, 直至电池电量损耗完后自动关机; 放入14500电池, 电压低于3V时, 会依次降档直至关机, 有效防止电池过放. 放入14500电池且开机到最高亮档档位时, 高亮状态3分钟后将自动降低亮度, 有利于避免过热导致手电电路元件和LED损坏, 同时增强握持温度舒适度.

电池安装



使用及维护

- 手电在使用过程中, 手电表面温度在60度以下属于正常情况, 请放心使用
- 充电电池出厂时只有50%以下电量, 直接使用不能达到最高

- 亮度 and 正常续航时间, 首次使用请将电池充满
- 为达到最佳防水性能, 请定期检查防水O圈的完整性, 并适量涂抹润滑硅脂于防水O圈上以延长其使用寿命. 如O圈损坏, 请及时更换原厂O圈以确保您所使用之产品的优异防水性能
- 请勿将手电筒的光线直接照射入人类或动物的眼睛
- 手电筒不用时, 可将筒身扭松, 避免误操作
- 长时间不使用手电筒时, 请将电池取出, 并妥善存放

保修

- 15天保质期: 自售出之日起15天内, 在正常使用情况下, 出现产品质量问题, 客户可选择更换新品或维修服务, 要求更换时, 所换产品应为返修产品同型号同规格的新品; 如同型号同规格的产品停止生产时, 则调换不低于原产品性能的同品牌产品
- 5年免费保修期: 自售出之日起5年内, 用户在正常使用情况下, 出现产品质量问题, 可享受免费维修服务
- 终身有限保修: 超过5年免费保修期外, 提供有偿保修, 费用以实际更换材料费用为准, 不另收取人工费



关注微信



进入官网



京东购买



淘宝购买

深圳市凯瑞兹电子科技有限公司

写字楼地址: 深圳市龙华新区布龙路1010号智慧谷创新园大楼521-525

工厂地址: 深圳市龙华新区民治牛栏前工业区26栋5楼

邮编: 518131

电话: +86-755-27700110

网站: www.klaruslight.cn

邮箱: info@klaruslight.com

